



BEARING HOUSING & ACCESSORIES



J & J Engineering & Journey

25 years ago it was a revolutionary era in bearings industry & that was the time when a revolutionary company J&J Engineering rooted his feet in bearing industry with the motto of giving quality products to the end users. Being the rich experience with great exposure to the outer world & new techniques too.

J&J Engineering has played a pioneering role in the growth of bearing housings in India. It has established itself as the market and brand leader in the bearing housings industry in India. The results of the vast experience, industry knowledge & efforts in the area of research and development led to a growing number of quality products that have created new standards and new products in the bearing world. They stand for quality and engineering excellence. Their operations in Ahmedabad plant are also in accordance with other internationally accepted processes.

The company has a very strong network in dealer around the country & has built a diverse product portfolio to meet the needs of different consumer segments, ranging from standard series in cast iron to advanced high performance custom designed products in customer specific material requirements.

Customized Product

J&J Engineering being a leading manufacturer & supplier of products it also deal with customized design according to client needs so it would be the only halt for end to end solution. The solutions and services in the area comprising Plummer blocks (bearing housings), bearing accessories & housing sealing solutions. Services include technical support & maintenance services.

Field Expertise

Bulk Material Handling

Sugar Plants

Steel Plants

Textile Machineries

Industrial fans

Heavy Eng. Industries

Cement factories & many more...

Tailor Made Housing

Water cooling jackets-Its quality container filled with water that surrounds a machine to cool it; especially that surrounding the cylinder block of an engine.

Oil mist lubrication-Its Oil mist lubrication systems are becoming increasingly popular in a variety of applications where only limited oil feed supply is required; include bearings of electric motors, pumps and compressors in many oil refineries and petrochemical plants.

RTD probe provision-Probes and probe accessories are carefully designed and manufactured according to strict tolerances and specifications. The J&J E Engineering RTD probe design team uses modern tools to develop, model and engineer tailor-made probe solutions.

Vision

Become the gigantic engineering product manufacture company.

Mission

To provide the latest & quality products in bearing industry.

For our customers

Delivering industry-leading, high value products, services and knowledge-engineered solutions within shortest possible periods at best prices possible.

Quality Policy

Quality is what J&J stands for and the key to their global competitiveness. With the most advanced manufacturing facilities equipped with state-of-the-art automated machines, we guarantee to provide our customers with unparalleled quality product.

Future at J&J Engineering

Seek to provide the most high quality products in the bearing housings industry. Products designs are made for customers benefit. From the most basic features to the most sophisticated designs, the products are designed to give customers substantial value.

J&J Engineering is recognized as the new benchmark for modern bearing housings technology, superior quality and personalized service that has ensured our product and nationwide acclaim in the industry.



Basic Information for PDN Series

PDN Series Bearing Housing Suitable for two deep groove ball bearings or one deep groove bearing on one end and one cylindrical roller bearing on other end.

PDN 200 Series suitable for 6200 and NU 200 Series bearings.

PDN 300 Series suitable for 6300 and NU 300 Series bearings.

Illustration for PDN Series

Basic Design :

Prefix for housing: Housing for

-Normal radial' and axial loads

-Predominant or alternating axial loads

- Heavy radial and normal axial loads

Prefix for unit (Housings, Bearings and shaft) :

Housing	Bearing type') Non-locating Side	Locating Side	
PDN	BB1	BA2	A
PDN	BB1	BB1	B
PDN	BC1	BC1	D
PDN	BC1	BB1	E
PDN	BC1	BA2	F
PDN	BS2	BS2	L
PDN	BC1	BS2	M
PDN	BS2	BB1	T
PDP	BC1	BC1	D
PDP	BC1	BB1	E
PDP	BC1	BA2	F
PDP	BC1	BS2	M
PDR	BC1	BC1-BB1	J

1) BA2= Matched set of 2 angular contact ball bearings

BB1= Deep groove ball bearing

BC2= Spherical roller bearing

Size designation:

e.g.305

Supplementary designations

Spacers and large bore in end cover
At both sides

PDP or PDR housing without spacers

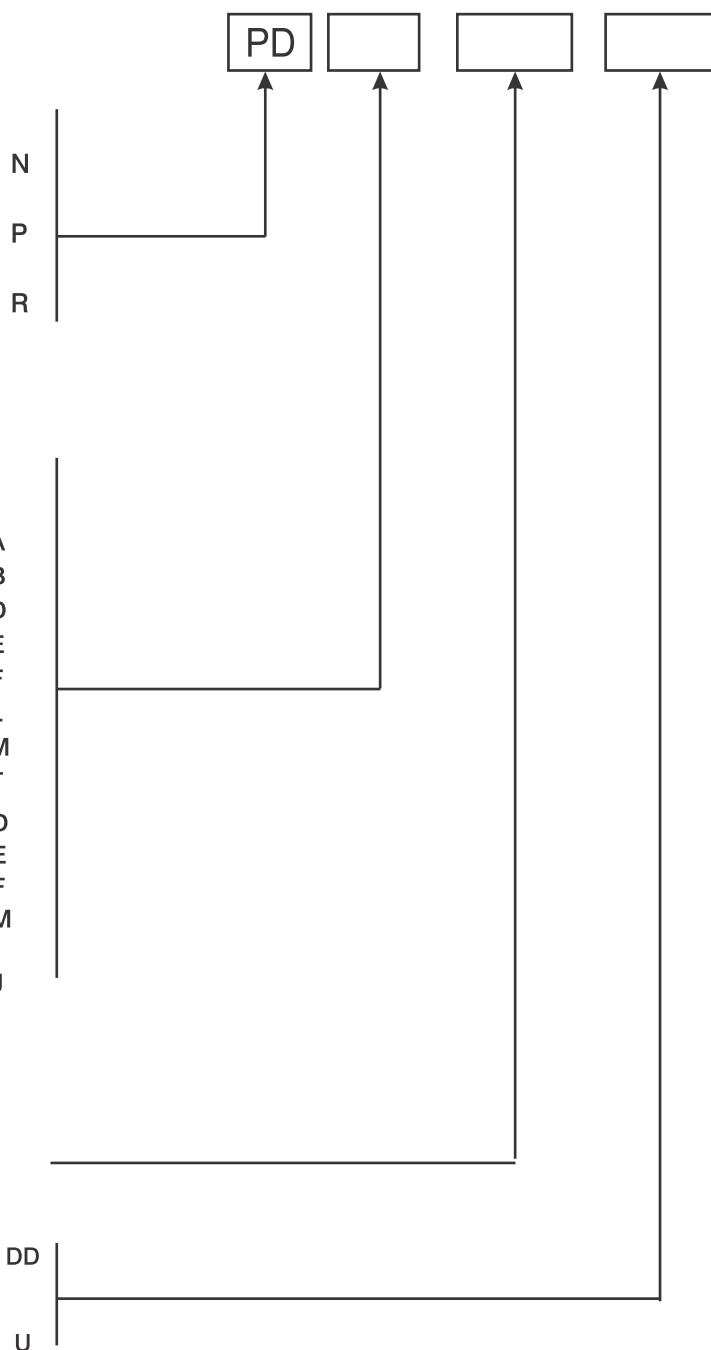

PDN-Series

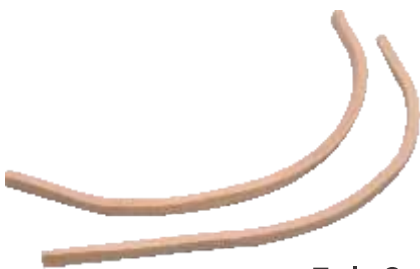

Felt Seal



Distance Ring

PDN Two-Bearing Housing 25 MM to 120 MM 200 & 300

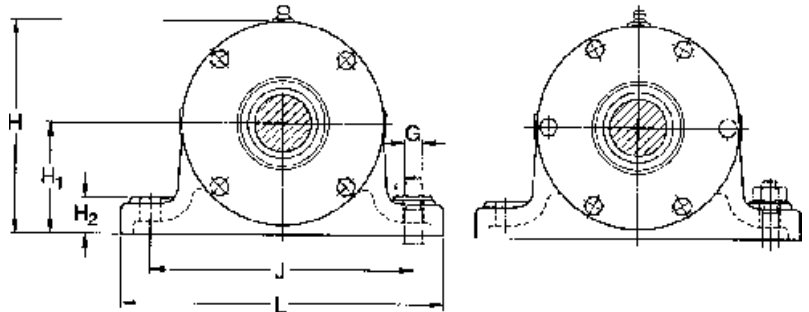
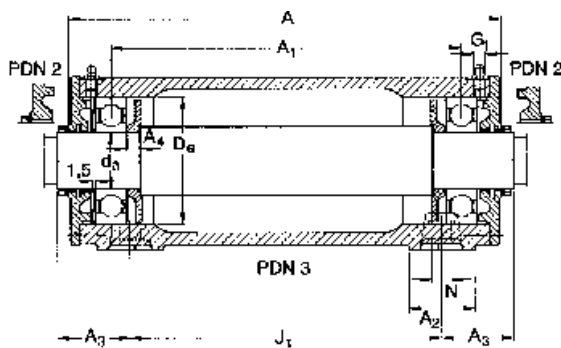

Sizes upto and including PDN 211 and PDN 309 Sizes from PDN 212 and PDN 310

SHAFT DIA d _a mm	Housing Dimensions (mm)															Designations	Appropriate bearing	Seperate Components Spring Washer ¹	V-ring	Felt Strip
	A	A ₁	A ₂	A ₃	A ₄	D ₆	H	H ₁	H ₂	J	J ₁	L	N	G	G ₁					
25	202	146.5	35	40.5	7	62	95	50	16	120	135	155	12	10	G ¹ / ₈	PDN 305	6305	WF-62	V-25 A	FS 190
30	197	147.5	35	37.5	7	62	95	50	16	120	135	155	12	10	G ¹ / ₈	PDN 206	6206	WF-62	V-30 A	-
	226	171.5	40	45	7	72	100	50	18	130	150	160	15	12	G ¹ / ₈	PDN 306	6306	WF-72	V-30 A	FS 190
35	227	173.5	40	45	7	72	100	50	18	130	150	160	15	12	G ¹ / ₈	PDN 207	6207	WF-72	V-35 A	-
	260	195.5	45	49.5	8	80	116	60	18	150	175	190	15	12	G ¹ / ₈	PDN 307	6307	WF-80	V-35 A	FS 190
40	259	198.5	45	49.5	8	80	116	60	18	150	175	190	15	12	G ¹ / ₈	PDN 208	6208	WF-80	V-40 A	-
	315	255.5	52	53	10	90	121	60	20	150	225	190	15	12	G ¹ / ₈	PDN 308	6308	WF-90	V-40 A	FS 190
45	360	279.5	52	63	10	100	137	70	22	170	250	210	15	12	G ¹ / ₈	PDN 309	6309	WF-100	V-45 A	FS 190
50	314	258.5	52	52	10	90	121	60	20	150	225	190	15	12	G ¹ / ₈	PDN 210	6210	WF-90	V-50 A	-
	377	311.5	60	59	10	110	142	70	25	170	275	210	15	12	G ¹ / ₈	PDN 310	6310	WF-110	V-50 A	FS 260
55	356	283.5	52	60.5	10	100	137	70	22	170	250	210	15	12	G ¹ / ₈	PDN 211	6211	WF-100	V-55 A	-
	422	335.5	60	69	10	120	158	80	25	210	300	260	19	16	G ¹ / ₈	PDN 311	6311	WF-120	V-55 A	FS-260
60	376	316.5	60	58	10	110	142	70	25	170	275	210	15	12	G ¹ / ₈	PDN 212	6212	WF-110	V-60 A	-
	460	383.5	70	68	10	130	165	80	25	210	340	260	19	16	G ¹ / ₈	PDN 312	6312	WF-130	V-60 A	FS 260
65	492	402.5	70	74	11	140	185	95	25	230	360	280	19	16	G ¹ / ₄	PDN 313	6313	WF-140	V-65 A	FS 260
70	459	390.5	70	69	10	125	165	80	25	210	340	260	19	16	G ¹ / ₈	PDN 214	6214	WF-125	V-70 A	-
	512	420.5	70	76	11	150	190	95	25	230	380	290	19	16	G ¹ / ₄	PDN 314	6314	WF-150	V-70 A	FS 330
75	459	389.5	70	69	10	130	165	80	25	210	340	260	19	16	G ¹ / ₈	PDN 215	6215	WF-130	V-75 A	-
	547	448.5	80	83.5	12	160	200	100	30	260	400	320	19	16	G ¹ / ₄	PDN 315	6315	WF-160	V-75 A	FS 330
80	493	409.5	70	76	11	140	185	95	25	230	360	280	19	16	G ¹ / ₄	PDN 216	6216	WF-140	V-80 A	-
	556	466.5	80	78	12	170	220	112	30	260	420	320	19	16	G ¹ / ₄	PDN 316	6316	WF-170	V-80 A	FS 330
85	590	486	80	85	12	180	225	112	30	290	440	350	19	16	G ¹ / ₄	PDN 317	6317	-	V-85 A	FS 330
90	543	455.5	80	81	12	160	200	100	30	260	400	320	19	16	G ¹ / ₄	PDN 218	6218	WF-160	V-90 A	-
	605	510	85	82.5	11	190	230	112	30	290	460	350	19	16	G ¹ / ₄	PDN 318	6318	-	V-90 A	FS 370
95	648	540	90	94	13	200	253	125	36	320	480	400	24	20	G ¹ / ₄	PDN 319	6319	-	V-95 A	FS 370
100	588	493	80	83.5	12	180	225	112	30	290	440	350	19	16	G ¹ / ₄	PDN 220	6220	-	V-100 A	-
	673	570	95	96.5	11.5	215	264	130	40	320	500	400	24	20	G ¹ / ₄	PDN 320	6320	-	V-100 A	FS 460
110	634	547	90	88	13	200	253	125	36	320	480	400	24	20	G ¹ / ₄	PDN 222	6222	-	V-110 A	-
	686	580	95	94.5	10	240	296	150	40	380	520	450	28	24	G ¹ / ₄	PDN 322	6322	-	V-110 A	FS 460
120	672	577	95	97	11.5	215	264	130	40	320	500	400	24	20	G ¹ / ₄	PDN 224	6224	-	V-120 A	-
	707	600	100	96	11.5	260	322	160	40	410	538	500	35	30	G ¹ / ₄	PDN 324	6324	-	V-120 A	FS 460